

SCHMIDT® HydroPneumaticPress

H-Frame design with and without force/stroke monitoring

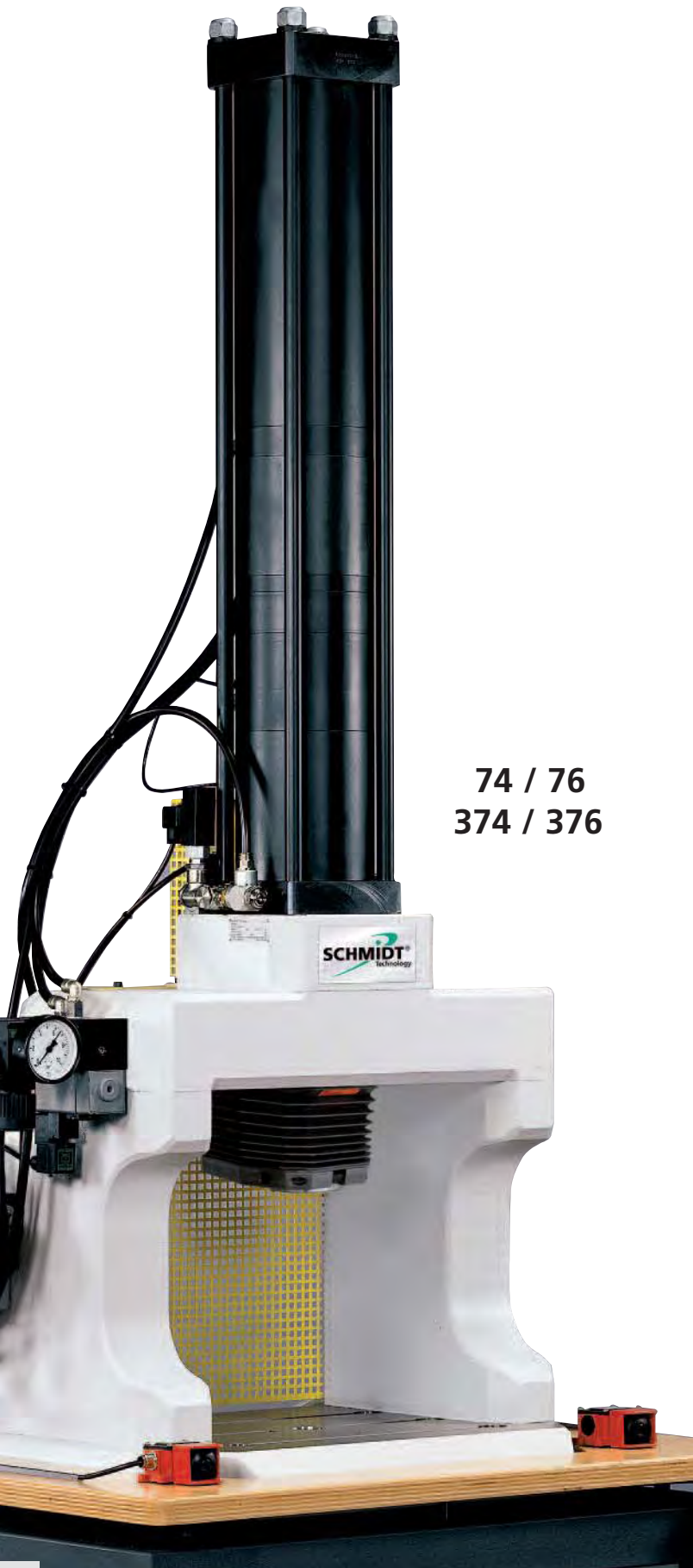

74 / 76
374 / 376



Round ram locked against rotation with TDC switch (74/76) or position measuring system (374/376) on the rotational guide rod.

Features:

- Stable frame with low bending for the absorption of high forces.
- Flexible tool location in the fixture mounting plate due to replaceable centering bushing with precision bore.
- The large working area offers sufficient space for large tools.
- The force is determined via a pressure transducer with force/stroke monitored presses.

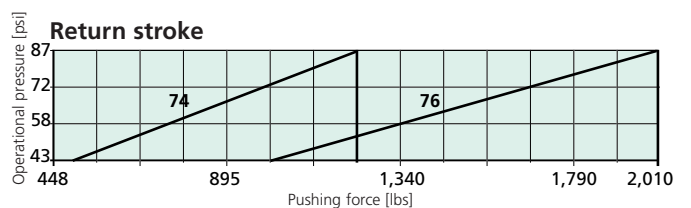
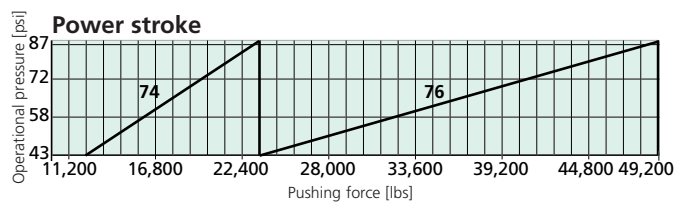
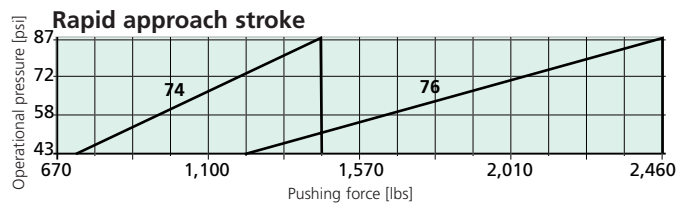
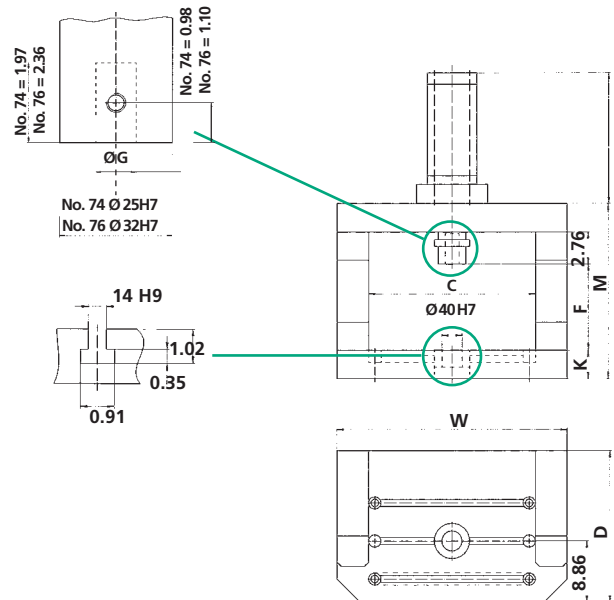

From 100 kN to 220 kN / 22,480 lbs. to 49,460 lbs. in power stroke

Press type		74	76
Total stroke – power stroke ¹⁾	mm	100-12	100-12
Nominal force at 87 psi	lbs	22480	49460
Ram bore	Ø mm	25H7	32H7
External ram dimensions	Ø inch	2.76	3.54
Working height	F inch	13.78	13.78
Table height	K inch	3.74	3.74
Frame height	M inch	25.20	25.20
Table size	W x D inch	27.56 x 21.65	27.56 x 21.65
Table bore	Ø mm	40H7	40H7
Clearance	C inch	16.53	16.53
Clearance \circ	inch	20.47	20.47
Weight (standard)	approx. lbs	1610	1675

Press type		374	376
Total stroke – power stroke ¹⁾	mm	100-12	100-12
Nominal force at 6 bar	lbs	22480	49460
Resolution, process data acquisition			
– stroke	inch	0.0002	0.0002
– force	lbs / inc	11.24	22.48
Ram bore	Ø mm	25H7	32H7
External ram dimensions	Ø inch	2.76	3.54
Working height	F inch	13.78	13.78
Table height	K inch	3.74	3.74
Frame height	M inch	25.20	25.20
Table size	W x D inch	27.56 x 21.65	27.56 x 21.65
Table bore	Ø mm	40H7	40H7
Clearance	C inch	16.53	16.53
Clearance \circ	inch	20.47	20.47
Weight (standard)	approx. lbs	1610	1675

Options

\circ = Additional charge applies

¹⁾ = Special models total stroke / power stroke on request

Imperial version presses available upon request.

Please consult our sales department or representative.

Dimensions are converted from metric units, most are approximate. Detailed dimensional drawings can be downloaded from our website: www.schmidtpresses.com

Stroke Length Conversions

50 mm	1.97 inch
100 mm	3.94 inch
150 mm	5.90 inch
6 mm	0.24 inch
12 mm	0.47 inch
20 mm	0.79 inch
30 mm	1.18 inch
36 mm	1.42 inch

Tolerance conversion of typical sizes of SCHMIDT® Presses

Metric	Nominal Inch	Tolerance Inch
10H7	0.3937	-0 / +0.0006
20H7	0.7874	-0 / +0.0008
25H7	0.9842	-0 / +0.0008
40H7	1.5748	-0 / +0.0010
10H9	0.3937	-0 / +0.0014
Threads	Pitch	
M8	1.25mm	
M10	1.50mm	

Accessories



High-pressure switch

After switching from rapid approach stroke to power stroke, the oil pressure rises in the hydraulic chamber of the cylinder. The high-pressure switch can be adjusted to reach a determined press force through the output generated by the oil pressure in the press.



Adjustment bushing for SCHMIDT® HydroPneumaticPress No. 74 and 76 gantry presses

For a simplistic adjustment of the working height with a setting range of 100 mm. This greatly reduces the need for spacers to accommodate different working heights during setup changes.



Oil pump

For a bubble-free refilling of the SCHMIDT® HydroPneumaticPress with hydraulic oil.